



08/20/2019
Douglas A. DeLong, Landscape Architect LA-81

Consultants:

Planting Requirements:

Olive Frontage-75 PU/100 lf
286 lf/100x75=214.5 PU

Fricse Drive-80 PU/100 lf
250 lf/100x80=200 PU

North Parking 40 PU/100 lf
246 lf/100x40=98.4 PU
50% to be shrubs

West Parking 40 PU/100 lf
147 lf/100x40=58.8 PU
50% to be shrubs

South Parking 40 PU/100 lf
203 lf/100x40=81.2 PU
50% to be shrubs

**New Apartment Project
9473 Olive Blvd**

Olivette, MO. 63132

Revisions:

Date	Description	No.

Drawn: BD
Checked: DD

DeLong
landscape
Architecture, LLC
7620 West Bruno Ave
St. Louis, MO. 63117
(314) 346-4856
delong.la@gmail.com
Missouri State Certificate of Authority: 620130001045

Sheet Title: Landscape Plan

Sheet No: **L-1**

Date: 08-20-2019
Job #: 200.001

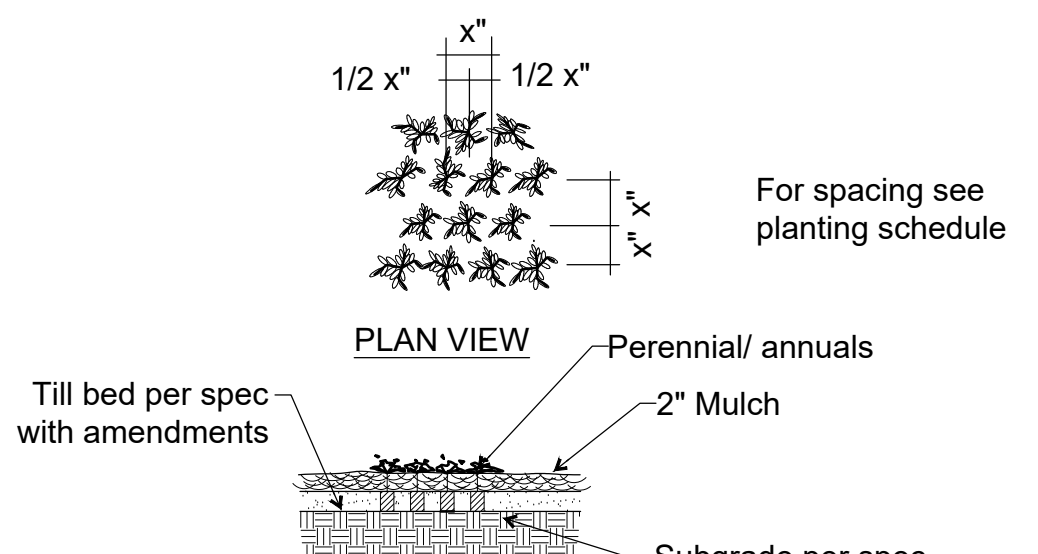
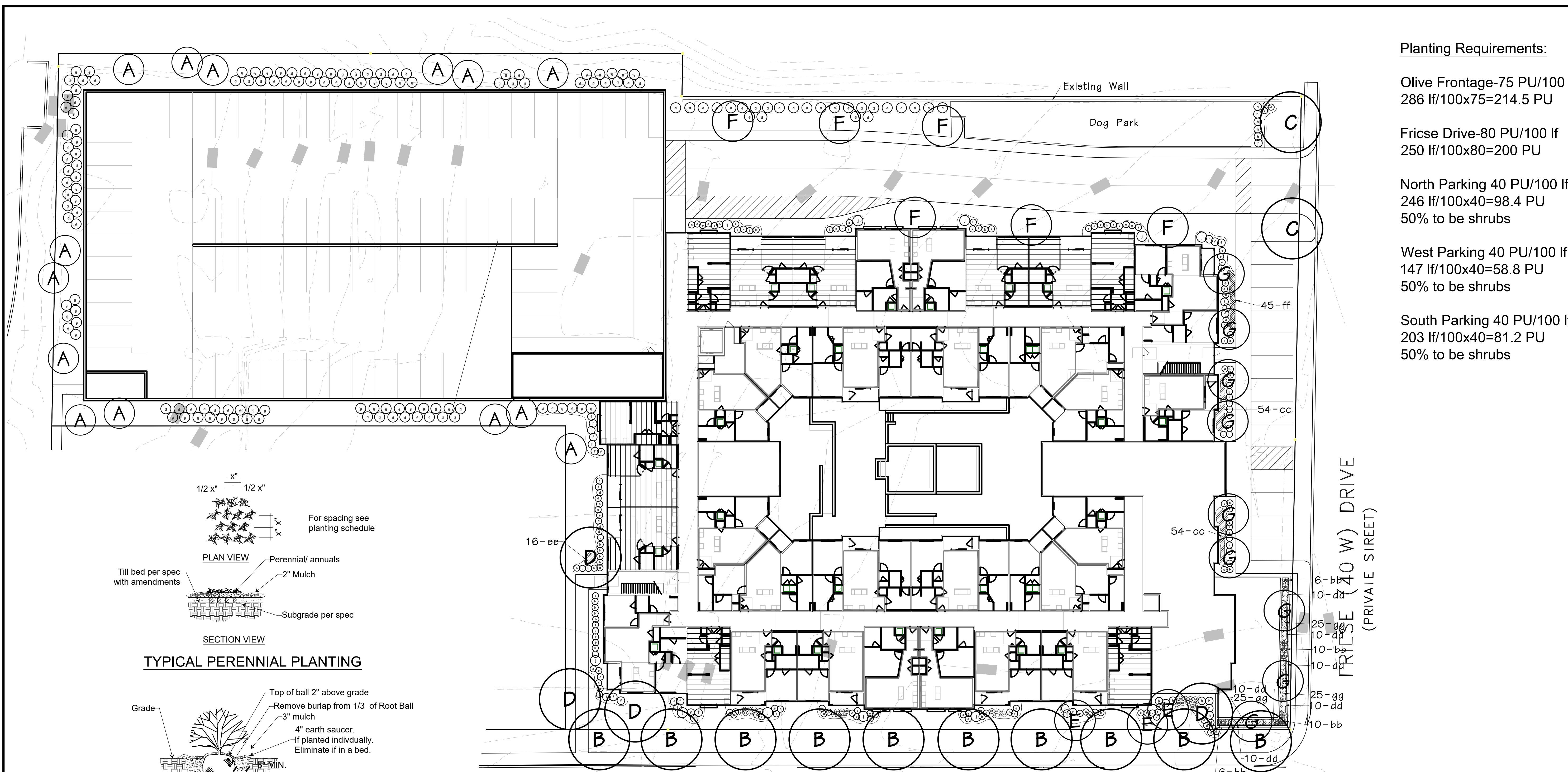

TYPICAL PERENNIAL PLANTING

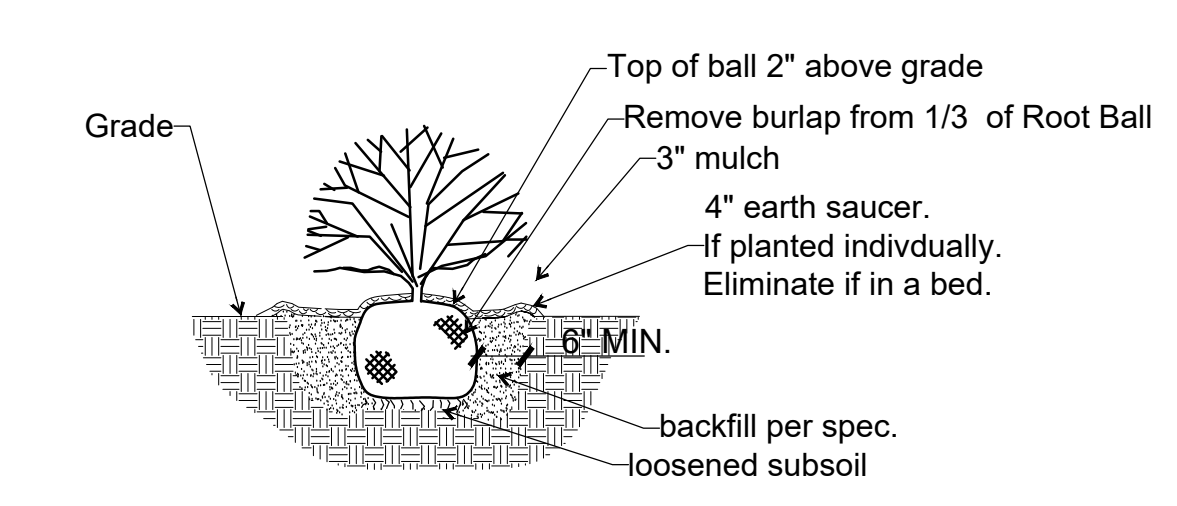

TYPICAL SHRUB PLANTING

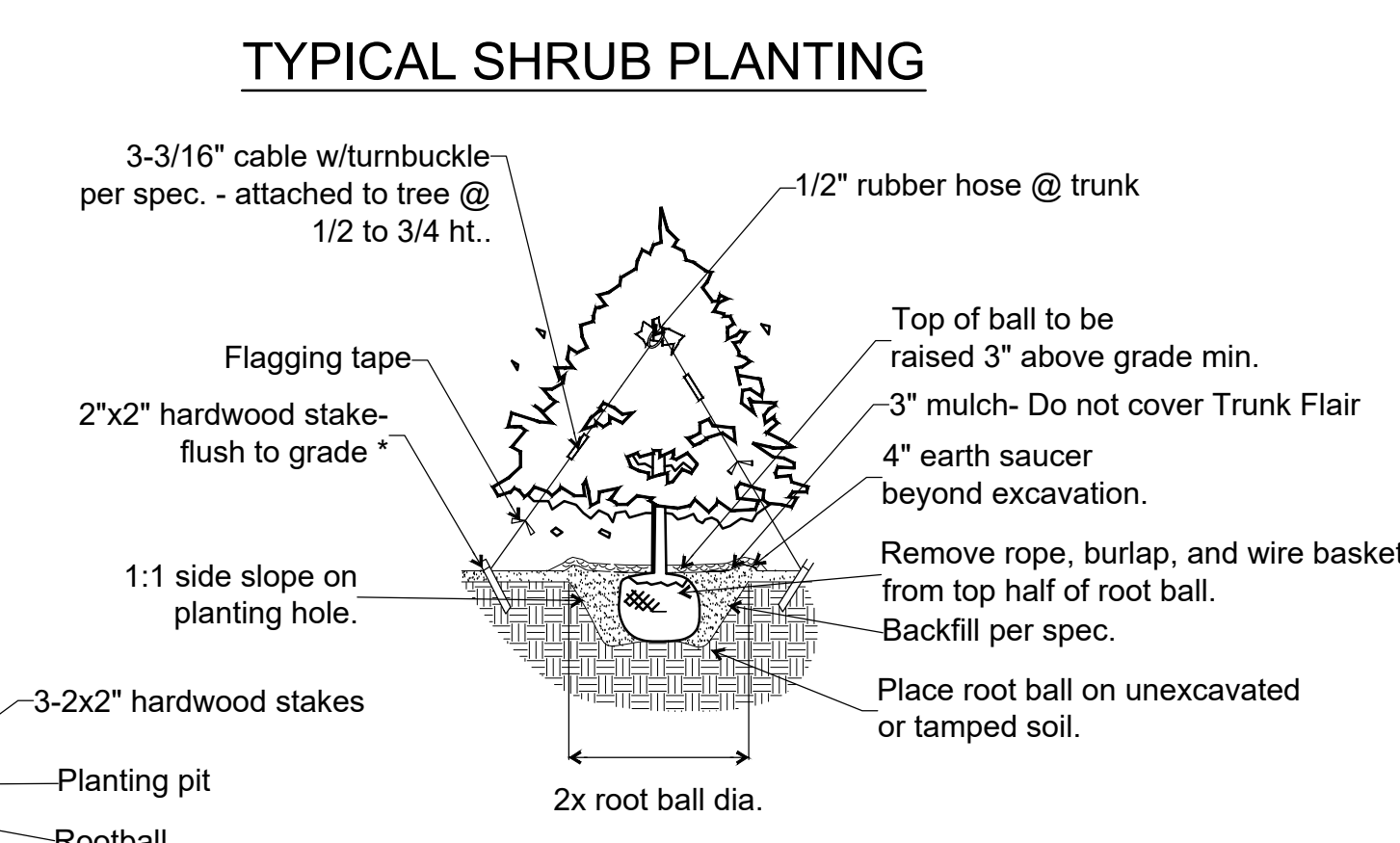

TYPICAL EVERGREEN PLANTING

- * Staking should be done only when:
 - Planting in soft, loose soils
 - Root balls with sandy soil, or wet clay
 - Trees located in an extremely windy location

**OLIVE STREET (60'W) ROAD
(PUBLIC STREET)**

NOTE: An in-ground irrigation system will be installed.

**Landscape Plan
SCALE 1"=20'**

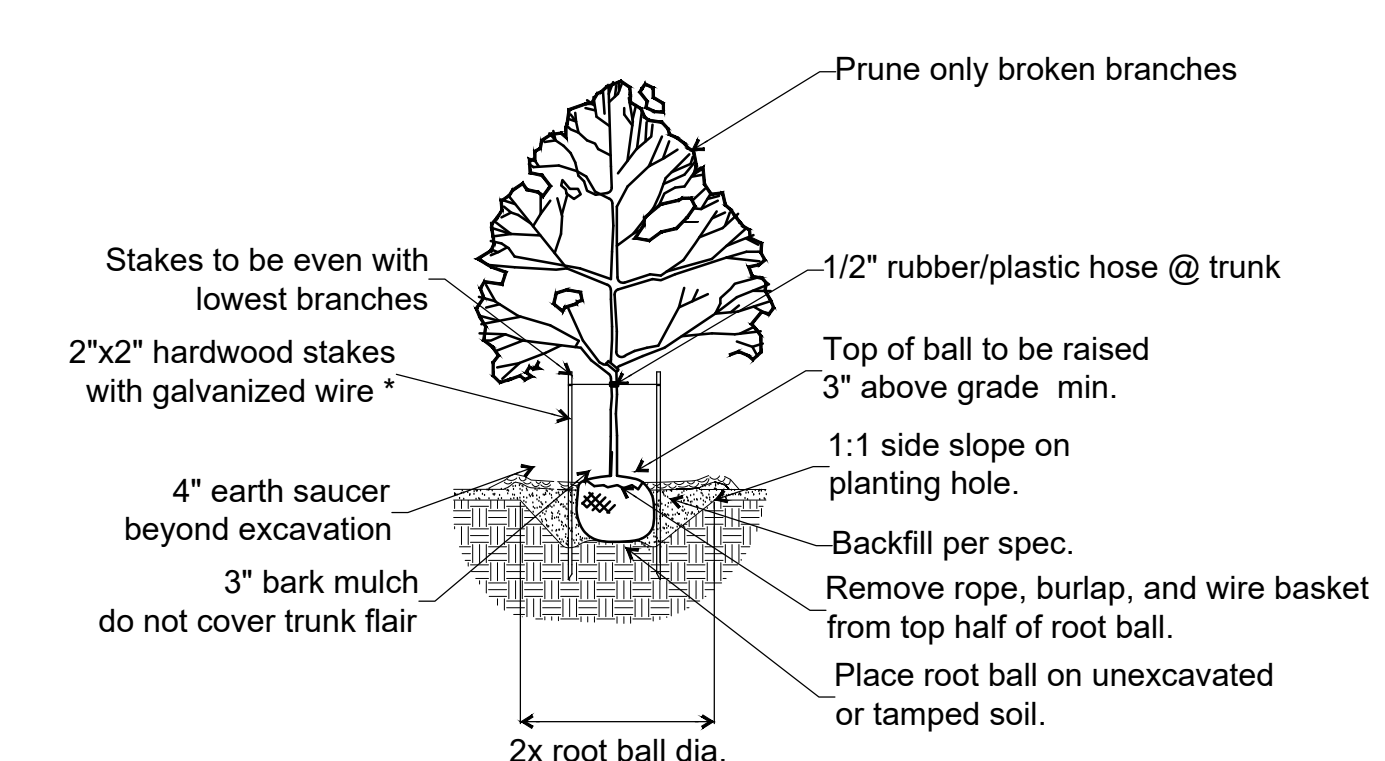

DECIDUOUS TREE PLANTING

SYMBOL	QUANTITY	BOTANICAL NAME	COMMON NAME	SIZE	REMARKS
A	14	<i>Picea abies</i>	Norway Spruce	10'	
B	10	<i>Acer rubrum 'October Glory'</i>	October Glory Red Maple	2.5'	
C	2	<i>Tilia euchlora 'Redman'</i>	Redman Linden	2.5'	
D	4	<i>Betula nigra 'Heritage'</i>	Heritage River Birch	10' Clump	
E	3	<i>Cercis canadensis</i>	Redbud	2"	
F	6	<i>Cornus florida</i>	Dogwood	2"	
G	9	<i>Chionanthus virginicus</i>	Fringe Tree	2"	
a	15	<i>Thuja 'Green Giant'</i>	Green Giant Arborvitae	6-8'	
b	40	<i>Buxus microphylla 'Wintergreen'</i>	Wintergreen Boxwood	18-24"	
c	7	<i>Buxus x 'Green Mountain'</i>	Green Mountain Boxwood	2-3'	
d	22	<i>Spiraea x bumalda 'Crispa'</i>	Crisp Leaf Spirea	18-24"	
e	57	<i>Itea virginica 'Henry Garnet'</i>	Itea Henry Garnet	18-24"	
f	25	<i>Physocarpus opulifolius 'Summer Wine'</i>	Summer Wine Ninebark	18-24"	
g	135	<i>Vib. Lantana 'Mohican'</i>	Mohican Viburnum	18-24"	
h	13	<i>Hybiscus syriacus 'Antong Two'</i>	Lil' Kim Rose of Sharon	2-3'	
j	10	<i>Thuja occidentalis 'Smaragd'</i>	Emerald Arborvitae	4-6'	
k	24	<i>Hydrangea macrophylla 'Bailmer'</i>	Endless Summer Hydrangea	18-24"	
aa	29	<i>Calamagrostis acutiflora 'Karl Foerster'</i>	Karl Foerster Feather Reed Grass	1 Gal.	2.5' OC
bb	32	<i>Pennisetum alopecuroides 'Hameln'</i>	Hameln Dwarf Fountain Grass	1 Gal.	2' OC
cc	58	<i>Hemerocallis 'Stella de Oro'</i>	Stella de Oro Daylily	4" pot	12" OC
dd	60	<i>Coreopsis verticillata 'Moonbeam'</i>	Moonbeam Coreopsis	4" pot	12" OC
ee	16	<i>Sedum kamtschaticum var. ellacombeanum</i>	Pachy Sedum	2" C.P.	9" OC
ff	45	<i>Liriope muscari 'Big Blue'</i>	Big Blue Liriope	4" pot	12" OC
gg	75	<i>Rudbeckia fulgida 'Goldstrum'</i>	Black-Eyed Susan	4" pot	12" OC